

MRT CLASSIC MESH GATE



CHARACTERISTICS

SWING GATE

Embedded.
With 1 or 2 leaves.

GATE MESH

Steel galvanized & powder coated wire \varnothing 4.00mm.
50 x 50mm.

SQUARE POSTS

According to door measurements.

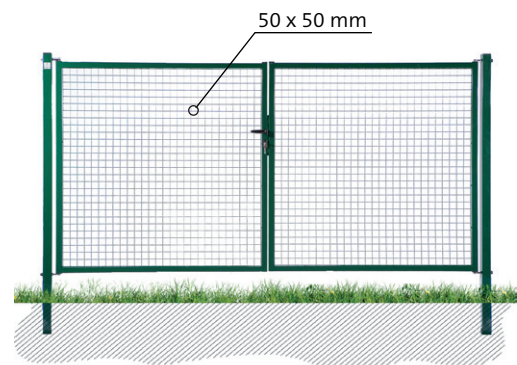

COMPONENTS

LOCK

- European cylinder.
- Stainless mechanism.
- Set of keys included.



LOCINOX® HINGE

- Heavy galvanized.
- Adjustable from 15 to 35mm.
- Aperture of 90°.
- Reversible: interior / exterior aperture.



AND FOR THE DOUBLE LEAF GATES:

GROUND STOP



DROPBOLT



STANDARD DIMENSIONS

The gates are delivered pre-assembled for a quick and easy installation. Reversible.

TYPE	Width in m	Height in m	Gate exterior dimension in mm	Fill panel in mm	Frame in mm	Post in mm	Post height in mm
SINGLE LEAF	1.00	1.00	1135	MESH 50 x 50 WIRE DIAMETER 4.00	40 x 40 x 1.50	60x60x1.50	1495
		1.20	1135				1695
		1.50	1135				1995
		1.70	1135				2195
		2.00	1135				2495
	1.50	1.00	1635				1495
		1.20	1635				1695
		1.50	1635				1995
		1.70	1635				2195
		2.00	1675				2545
	2.00	1.00	2135				1495
		1.20	2135				1695
		1.50	2135				1995
		1.70	2175				2245
		2.00	2175				2545
DOUBLE LEAF	3.00	1.50	3140	60x60x1.50	1995		
		1.70	3140	60x60x2.00	2195		
		2.00	3180	80x80x2.00	2545		
	4.00	1.50	4140	80x80x2.00	1995		
		1.70	4180	2245			
		2.00	4180	2545			

OTHER DIMENSIONS AVAILABLE UPON REQUEST.

FINISHING FEATURES

POWDER COATED

10 standard RAL colours:

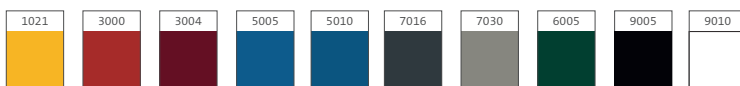

OXIDON

A metalized texture:



POST-GALVANIZED

Greater resistance:



10 YEAR WARRANTY

- Steel galvanized profile according to EN 10142 standards and hot dip galvanized wire according to EN 10244-2 standards.
- Polyester powder coating by microcrystalline phosphatation: 80 microns minimum.



ASSOCIATED PRODUCTS

PANEL HÉRCULES® PLUS

- 200 x 55mm mesh.
Ø 5.00mm steel galvanized & powder coated wire.

ACCESSORY

- This accessory allows to fixate the panel directly to the gate's column without adding the first post.

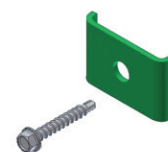
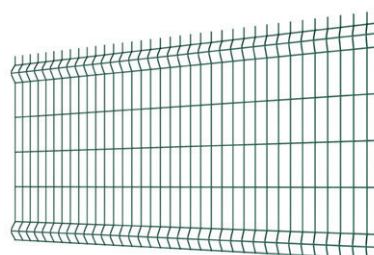

+150 YEARS OF EXPERIENCE
WILL ALWAYS MAKE THE DIFFERENCE